



Manual – Montageanleitung Rescue Plug

Impressum:

GIFAS-ELECTRIC GmbH
5301 Eugendorf bei Salzburg
Austria
www.gifas.at

Technische Änderungen und Irrtum vorbehalten.
Papierformat Manuel: A5

Dieses Manual ist Eigentum der GIFAS-ELECTRIC GmbH und darf ohne vorherige schriftliche Genehmigung durch GIFAS-ELECTRIC GmbH weder ganz noch in Auszügen kopiert, übersetzt, übertragen, dupliziert oder an Dritte weitergegeben werden.

Gruppe AP
Version: V1.00
Deutsch

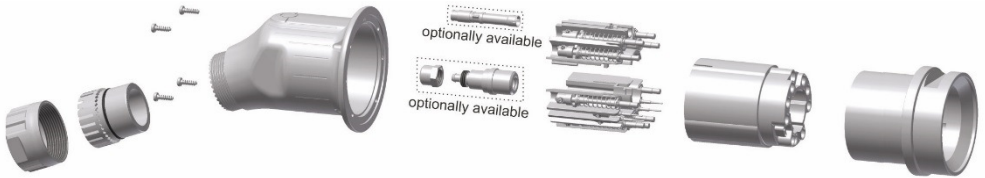

Montage Rescue Plug

1

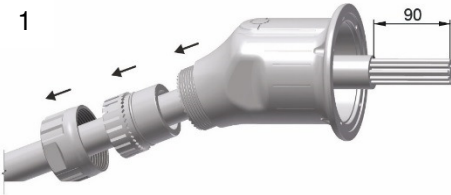

2

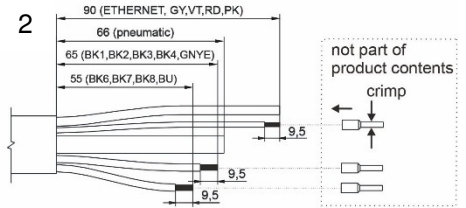

3

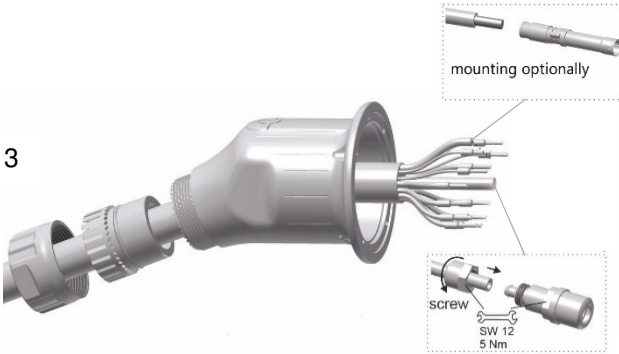

4

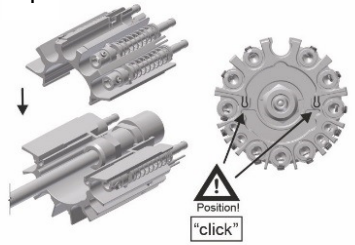

5

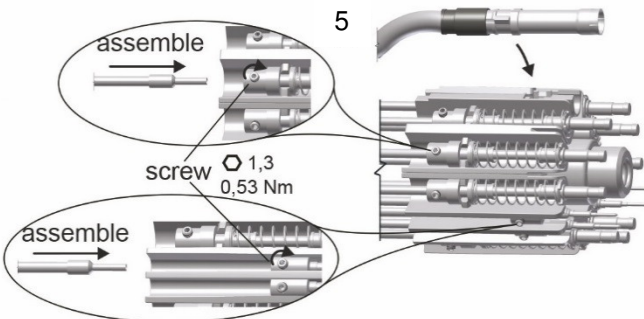

6



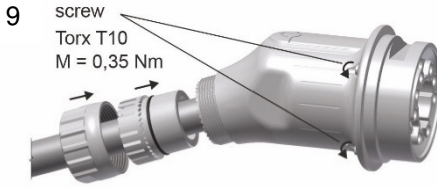
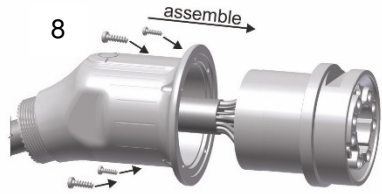
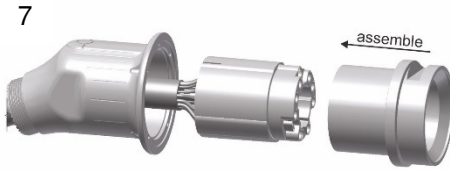

Montage BUS-Element

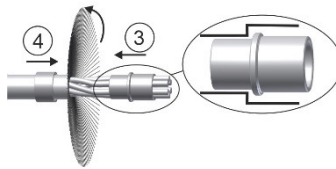
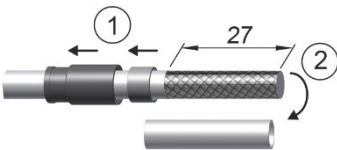

insert for local tool	hand tool	insert
CO.320.00	CO.282.00	CO.321.00

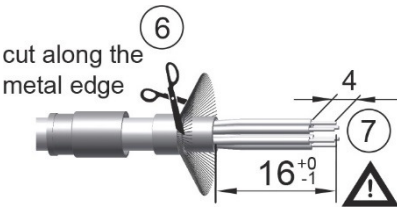
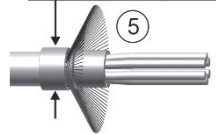

A [mm ²]	digital Crimp Tool No.:	Locator No.:	Pos.:
0,03 - 0,34	C0.235.00	C0.265.00	11
tool settings see crimp tool manual			

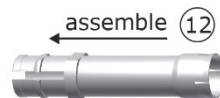
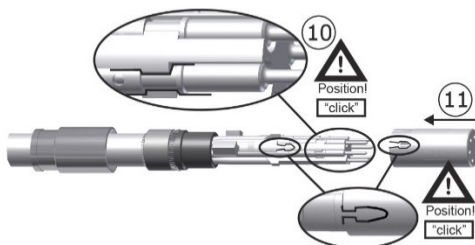
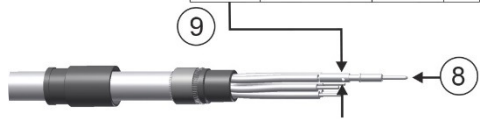

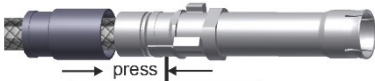

13

insert for local tool	hand tool	insert
C6.189.00	C0.282.00	C6.166.00

Systemkabel

Kabelstecker

